

RAM SIZE 280



S1 - 100%

Speed	N1B	[rpm]
Power	P	[kW]
Torque	T2N	[Nm]

Gear 1:1		Gear 5:1	
Speed	1500 7000	300 1400	
Power	97.1 97.1	94.2 94.2	
Torque	619 133	3000 643	

S6 - 40%

Speed	N1B	[rpm]
Power	P	[kW]
Torque	T2N	[Nm]

Gear 1:1		Gear 5:1	
Speed	1500 7000	300 1400	
Power	145.7 145.7	141.3 141.3	
Torque	928 199	4500 964	

Technical Features

Mounting position	
Control	
Interface	
Cooling/Flow rate	[l/mn]
Cooling/Loss power	[kW]
Bearings lubrication	
Lubrication/Flow rate	[l/mn]
Lubrication/Loss power	[kW]
Speed shifting/Pressure	[bar]
Speed shifting/Flow rate	[l/mn]

Mounting position	Vertical and horizontal
Control	Siemens/Fanuc/Heidenhain
Interface	Internal splines
Cooling/Flow rate	40
Cooling/Loss power	2.91
Bearings lubrication	Grease
Lubrication/Flow rate	3
Lubrication/Loss power	0.92
Speed shifting/Pressure	50 to 100
Speed shifting/Flow rate	8 to 10

RAM design for external forced lubrication

Interface

Gearbox only
Gearbox + Cooling Jacket
Gearbox + Cooling Jacket + output shaft arrangement

HIT	
FOT	
FOA	

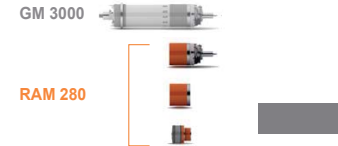

RAM SIZE 280

DIMENSIONS

HIT

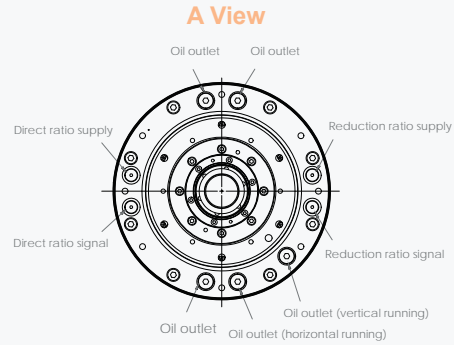

FOT

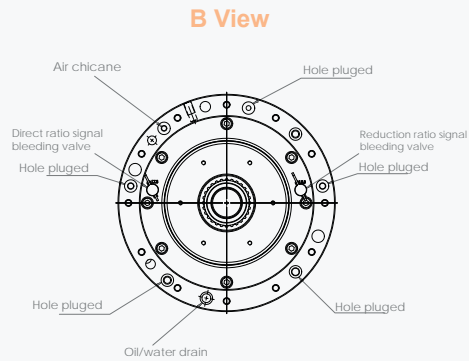

FOA

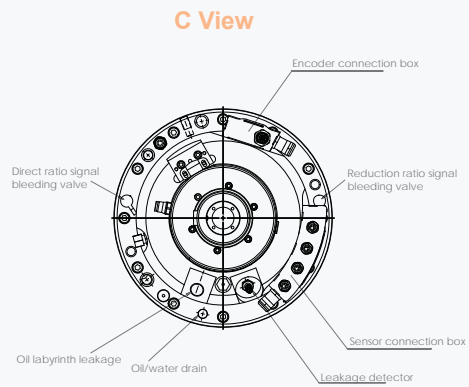

DIMENSIONS

GM 3000

RAM 280

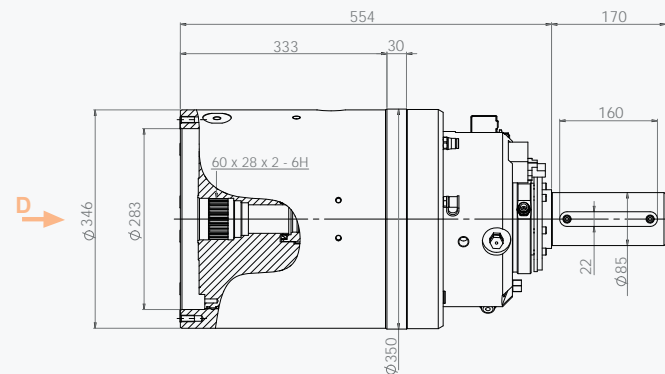
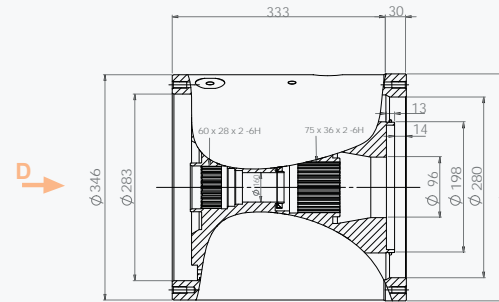
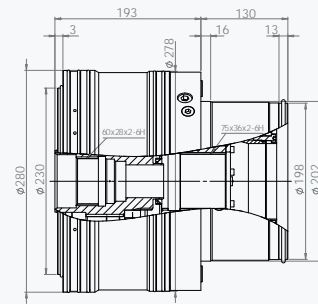

D View

