

RAM SIZE 250



S1 - 100%

Speed	N1B	[rpm]
Power	P	[kW]
Torque	T2N	[Nm]

Gear 1:1		Gear 5:1	
Speed	1500 8000	300 1600	
Power	60.2 60.2	58.4 58.4	
Torque	384 72	1860 349	

S6 - 40%

Speed	N1B	[rpm]
Power	P	[kW]
Torque	T2N	[Nm]

Gear 1:1		Gear 5:1	
Speed	1500 8000	300 1600	
Power	83.6 83.6	81 81	
Torque	532 100	2580 484	

Technical Features

Control	
Interface	
Cooling/Flow rate	[l/mn]
Cooling/Loss power	[kW]
Bearings lubrication	
Lubrication/Flow rate	[l/mn]
Lubrication/Loss power	[kW]
Speed shifting/Pressure	[bar]
Speed shifting/Flow rate	[l/mn]

Siemens/Fanuc/Heidenhain	
Internal splines	
	40
	1.81
	Grease
	2.5
	0.77
	50 to 100
	8 to 10

RAM design for external forced lubrication

Interface

Gearbox only
Gearbox + Cooling Jacket
Gearbox + Cooling Jacket + output shaft arrangement

HIT	
FOT	
FOA	

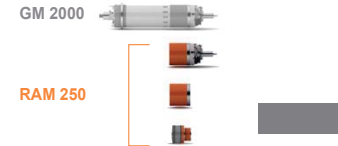

RAM SIZE 250

DIMENSIONS

HIT

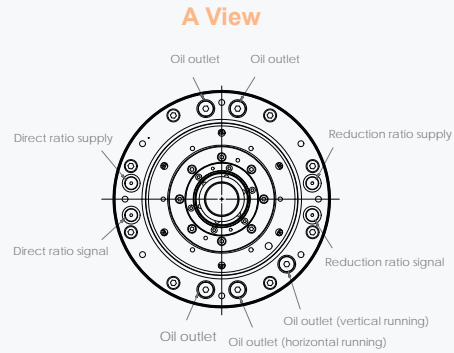

FOT

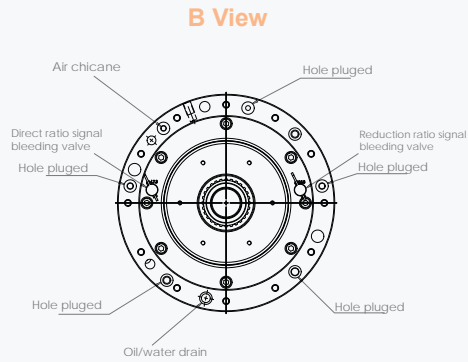

FOA

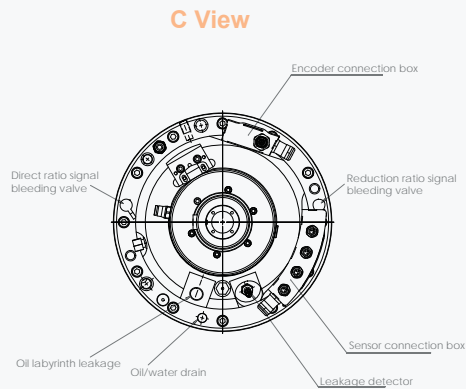

DIMENSIONS

GM 2000

RAM 250

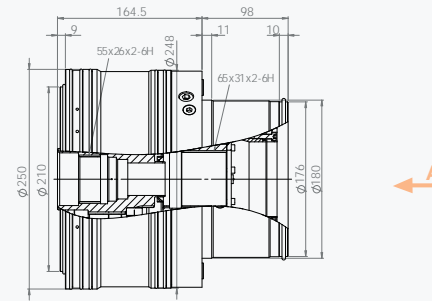

D

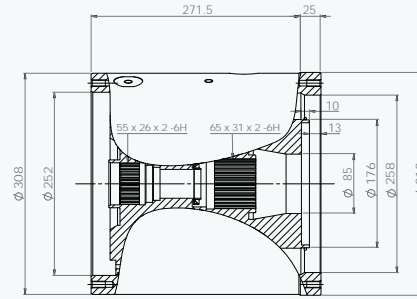

D View

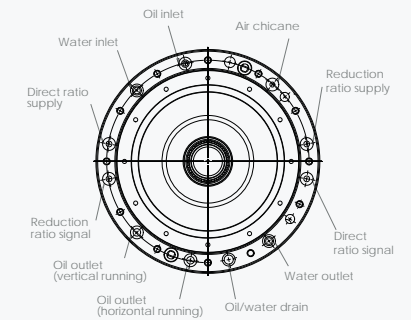

D

